

Operating Instructions

Encryption Program Turbine

The encryption program Turbine is freeware. If you would like to support the future development of an independent, strong and free for everyone encryption program, then please donate \$ 15 to the following bank account:

IBAN: DE82250100300159741907

BIC/Swift-Code: PBNKDEFF250

(bank account No.: 159741907, BLZ: 25010030, Postbank Hannover, Germany)

- 1) Push the button “Source file” to select the file you want to encrypt or decrypt
- 2) Push the button “Target file” to select a folder and to type in a filename and the suffix

Note: The suffix is freely selectable. Depends on this, nobody can see later directly that the Target file is an encrypted one. If you choose “.pdf” as the suffix of course you can't open the Target file with the PDF-program, because it isn't a pdf-format. But nobody see directly that you have encrypted files on your HDD-Drive.

- 3) Type in the key and confirm the key

After the first steps the Turbine window looks like this picture:

[picture 1: type in the key and confirm it]

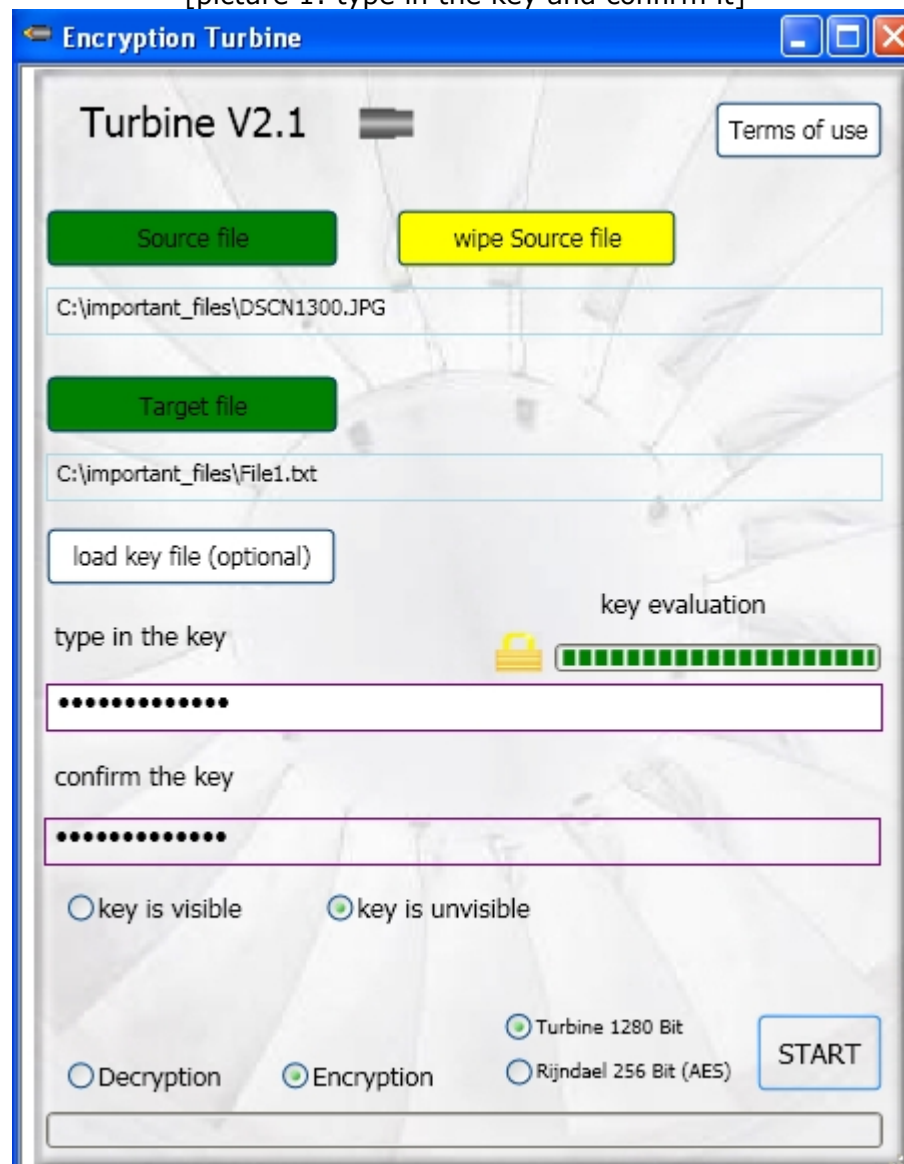

The key evaluation shows you the quality of the key. Keys with less than 6 characters are not allowed. Try to have a full green bar like in the picture above.

Optional to a manually key you can choose a key-file. The key-file can be a file of any kind and must be at least 7 kByte (eg a picture or a wav-file). Depends on the key-file Turbine generates a key with 1024 Characters.

If a key-file is loaded, the Turbine windows looks like this:

[picture 2: Turbine with a loaded key-file]

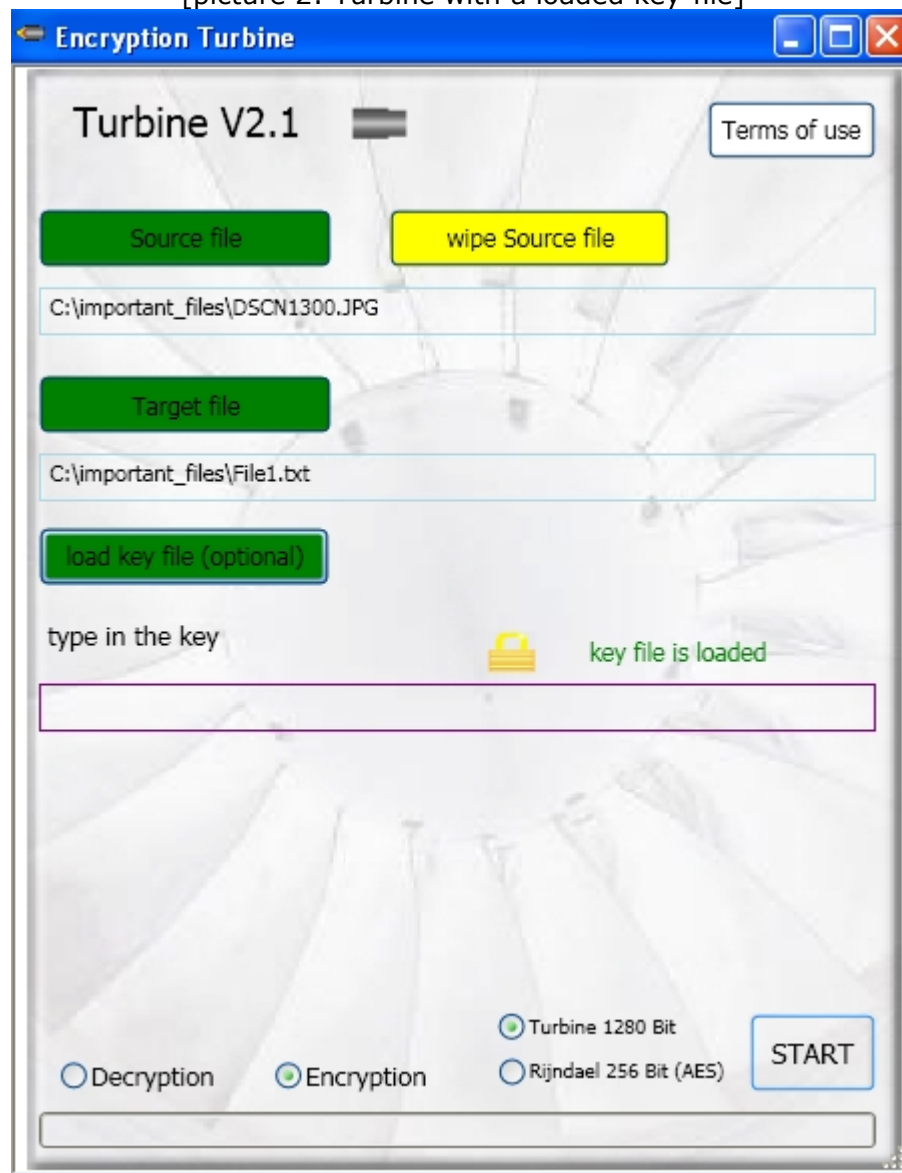

The key is hidden by default and you see only points. Select “key is visible” to see the key. If the key is “visible” it’s not necessary to confirm the key. When the key is “invisible”, it’s needful to confirm it before you can start the encryption or decryption.

The Turbine window with a visible key:

[picture 3: Turbine with a visible key]

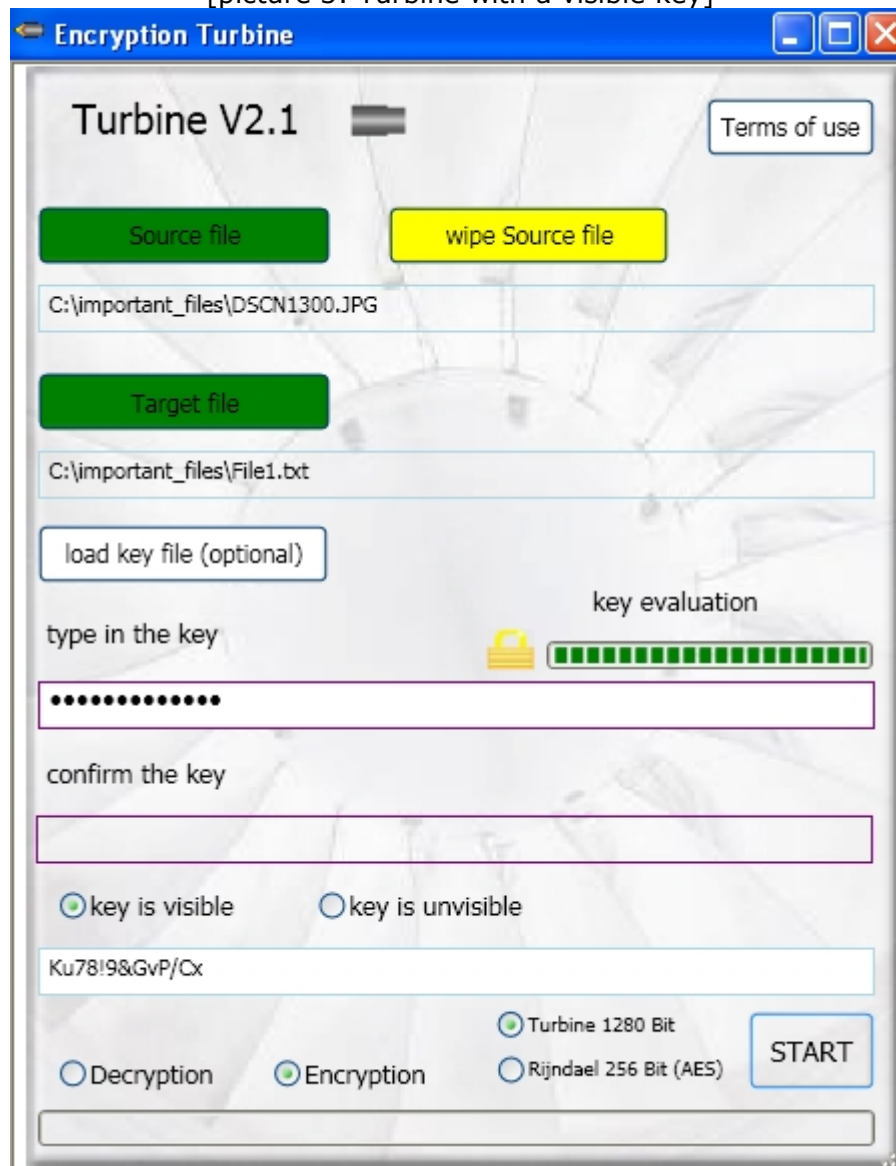
**You have 3 options:**

- 1) type in a key and confirm it
- 2) type in a key and set the key to visible
- 3) load a key-file

Tip: A good key is a random mix of uppercase and lowercase letters, numbers and special characters and has at least 10 characters (like in the picture above).

After that the user can select the algorithm. You have 2 options (default: Turbine is active):

- 1) Turbine 1280 Bit
- 2) Rijndael AES 256 (well-known and tested standard algorithm)

Note: It's also possible to encrypt a file twice. First with Turbine a second time with Rijndael (or vice versa).

Now you can select if you want to encrypt or decrypt (default: encryption is active).

When all fields are properly used you can start to encrypt or decrypt. To start push the START-button. The progress-bar shows you how many percent of the file are encrypt or decrypt.

Started Turbine:

[picture 4: Turbine after started the encryption]

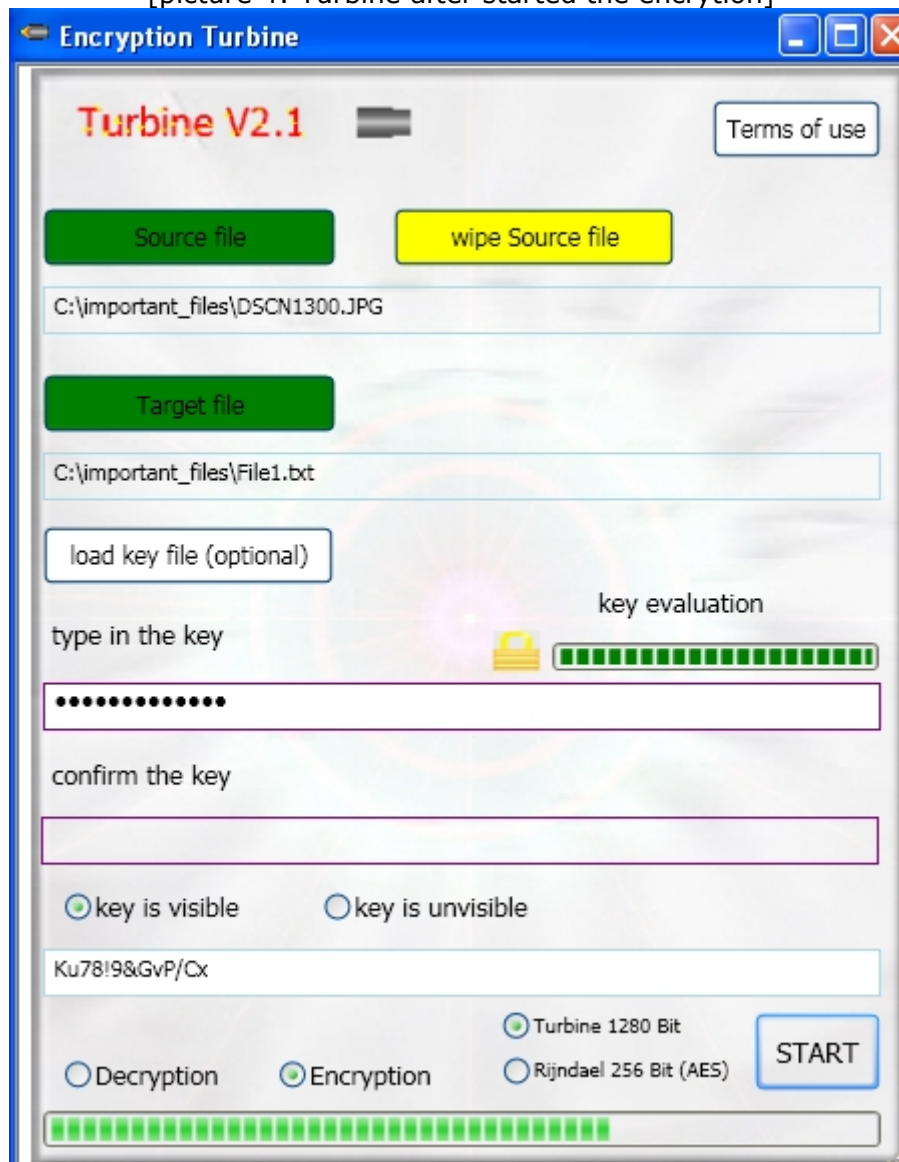

When the encryption or decryption was successfully the following window appears:

[picture 5: Encryption is finished]

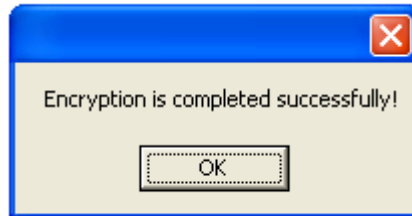

After you finished the process you can delete optional the Source file with the wipe-tool.

The wipe-tool overwrites the Source file ten times with different characters. A restoration is then no longer possible! To delete(wipe) the Source file press the yellow button "wipe Source file". A last "Warning" appears. Push "Yes" to start the deletion.

After a successfully deletion the following window appears:

[picture 6: Deletion is finished]

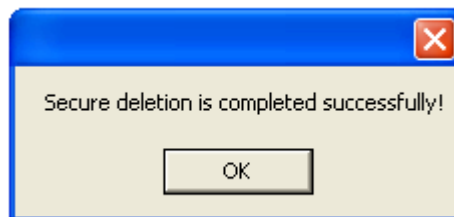

Of course you can use the wipe-tool of Turbine without an encryption or decryption before. For that select first a Source file and than push the button "wipe Source file" directly.

You can also run Turbine only to test your passwords that you use eg for your email-account or other programmss.

Start Turbine and type in a password (key) only:

[picture 7: Use Turbine to test your passwords]

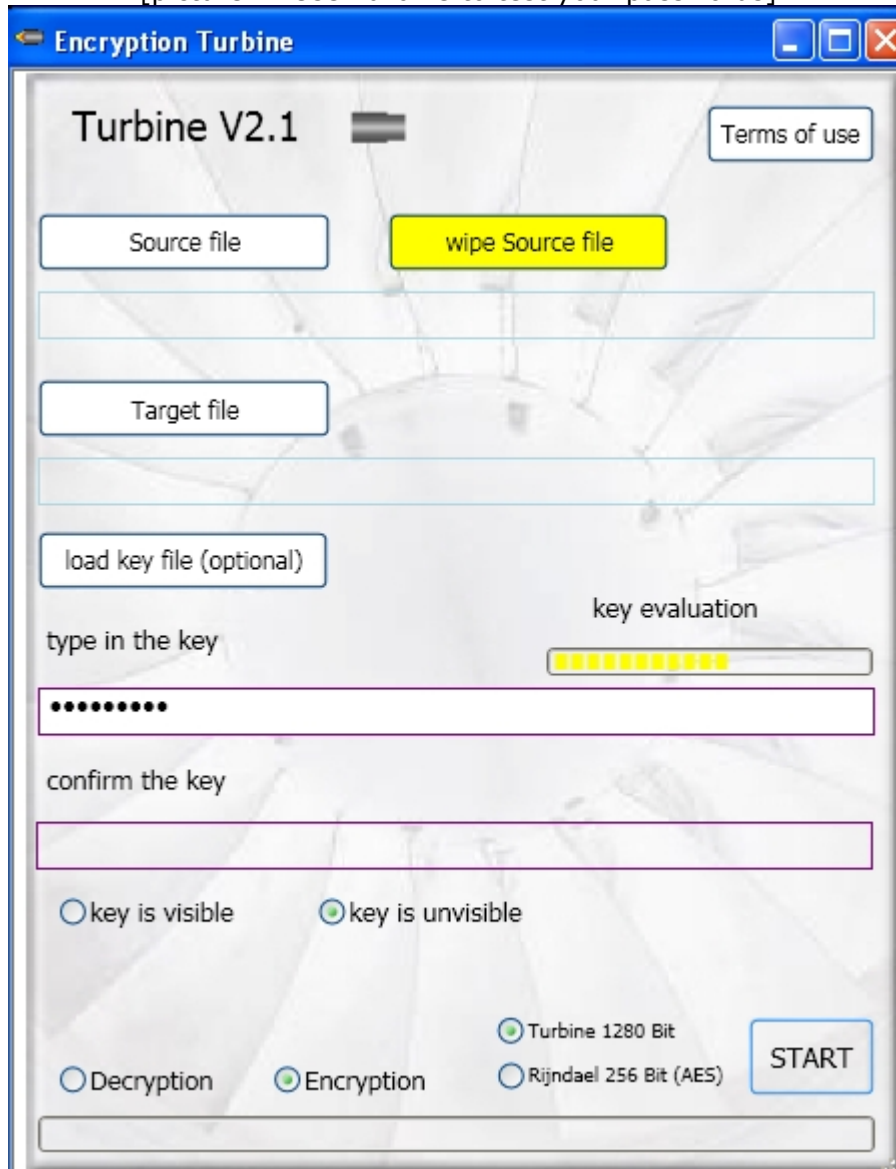

If the key evaluation is only „yellow“ like in the picture above or even worse, think about to change this password.